



Weber Adaptor Instructions

Weber Smokey Mountain Installation

Parts Needed:

- Deflector Plate
- Draft Inducer Tube
- Foil Tape



STEP 1

Open one of the dampers on the bottom of the Weber Smokey Mountain. Make sure the other dampers on the bottom are fully closed.

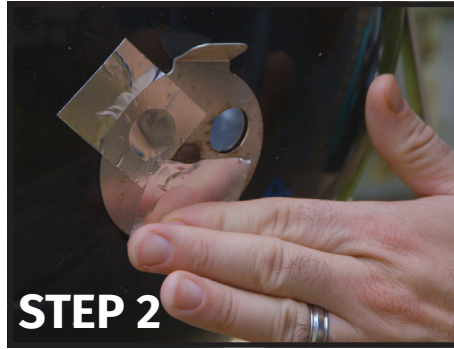

STEP 2

On the damper that you left open, cover all but one hole with the supplied high temperature Foil Tape. Trim if desired.



STEP 3

Insert the screw through the hole in the Deflector Plate.



STEP 4

Place the Deflector Plate on the inside of the cooker and push it through the open damper hole. Make sure the Deflector Plate opening is facing down.



STEP 5

With the threaded end closest to the damper hole, place the Draft Inducer Tube on the outside of the cooker and align it against the damper hole until the screw is inserted into the Draft Inducer Tube.



STEP 6

Rotate the Draft Inducer Tube in a clockwise direction until it is secured directly into the damper. If needed, use a screwdriver to ensure it is tight enough.



STEP 7

Insert the Pit Viper Fan into the Draft Inducer Tube. You are now ready to cook!



DEFLECTOR PLATE



DRAFT INDUCER TUBE

NOTE: Run your probes into your cooker at the top of your access door or under the lid.

IMPORTANT: Make sure the other two bottom dampers are fully closed when you are ready to cook.