



Grill Dome Cookers Instructions

Grill Dome Cookers Adaptor Door Installation

Parts Needed:

- Grill Dome Cooker Adaptor Door

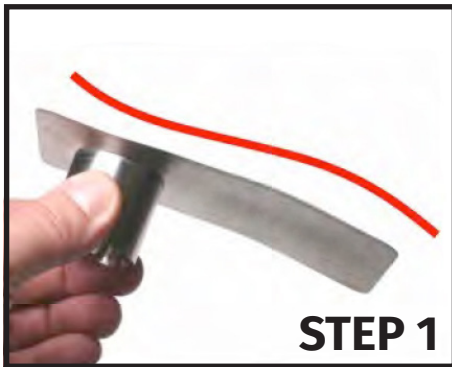

The Grill Dome Cooker Adaptor Door should be bent generally in the shape of the red line to cause it to seal tight in the track. You may shape the door to fit your needs.



As you slide the Adaptor Door in, the light gauge stainless steel sheet metal will easily conform to the track.



Using the Draft Inducer Sleeve as a handle, slide the Adaptor Door all the way to the left.



The above photo shows the Slip-in Adaptor Door sealed tight and ready to accept the BBQ Guru control. You are now ready to cook.

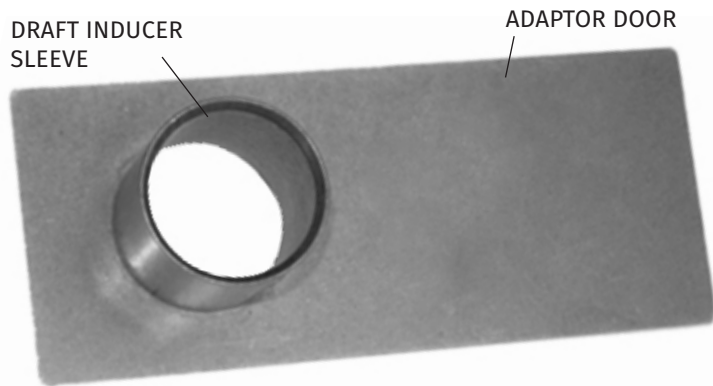

When removing the Adaptor Door, it may be necessary to pull out on the inducer sleeve to clear the right side edge of the clean-out opening.

NOTE: This adaptor is for small, medium, and large sized Grill Dome smokers.

NOTE: Run your probes into your cooker under the lid or through your top damper. Never run them through the firebox or bottom damper.